

Keithley Instruments, Inc.
28775 Aurora Road
Cleveland, Ohio 44139
1-888-KEITHLEY
<http://www.keithley.com>

High-Voltage Triaxial Feedthrough Connector

Description

The Model HV-CS-1613 is a high-voltage triaxial panel-mount feedthrough connector. You can use it with any customized test fixture or panel.

Figure 1: Model HV-CS-1613



Mechanical characteristics

Figure 2: Connector dimensions

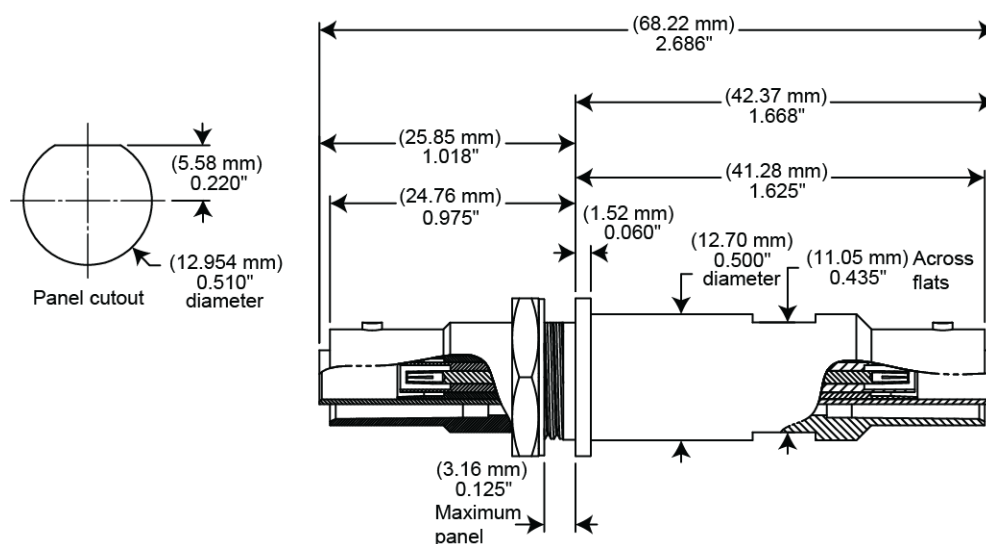

Electrical characteristics

- Maximum working voltage: ± 3300 V
- Maximum amperage: 2.0 A
- Mates with models: HV-CA-554 or SHV-CA-553
- Maximum torque: 15 in. lb.

