

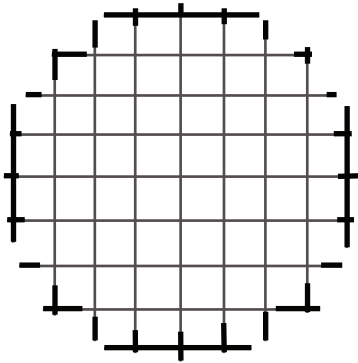

**CAUTION**

*Screen edges are sharp.  
Handle with care!*



**999-700**

Debris Screen for  
the FA-430 Nozzle



**AMERICAN HAKKO PRODUCTS, INC.**  
28920 AVENUE WILLIAMS VALENCIA, CA 91355, U.S.A.  
TEL: (661) 294-0090 FAX: (661) 294-0096  
Toll Free (800)88-HAKKO  
4 2 5 6  
<http://www.hakkousa.com>

*Thank you for  
purchasing  
the 999-700!*

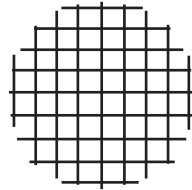

**1) Fit screen onto nozzle interior where duct will connect.**

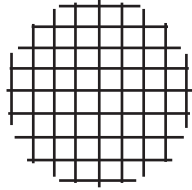

Align screen so that edges lay between tabs.

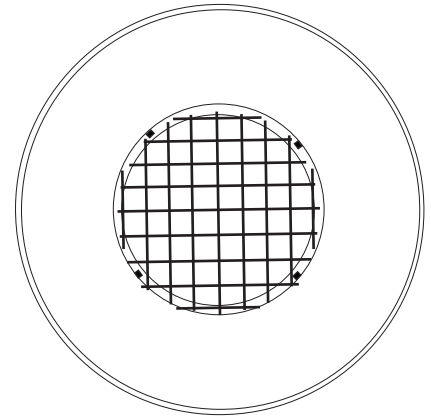

**2) Once screen is in place, attach duct back onto nozzle.**

Be sure the duct is facing in the proper direction during assembly.

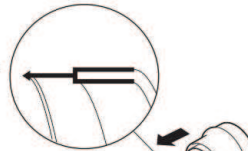

① Insert the nozzle until it stops.

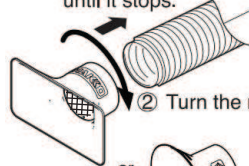

② Turn the nozzle clockwise.

or

